

# Digital Blaster™

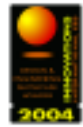

SDI Input (HD & SD) to DVI-D (HDCP) and RGBHV Video Output, with built-in Digital-In Digital-Out Digital Video Scaler and Digital Video Processor



Digital Blaster™ is the solution you've been looking for to interface your SDI-output products to your displays with DVI-D and HDMI inputs. Now you can affordably enjoy the quality and convenience of all-digital, crystal-clear pictures without the need to convert SDI to analog. With the power of Digital Blaster™ you have a built-in cable equalizer for the input, and a high-quality digital video scaler and processor for the output, to process the video and match the resolution of your displays. Digital Blaster™ supports DVI-D with HDCP, so truly all of your SDI sources can now drive your DVI-D and HDMI displays.

- SDI 270 Mb/s (SD) or 1.49 Gb/s (HD)
- Built-in SDI HD/SD input cable equalizer, accepts the 500-foot cable runs (SDTV) or 200-foot cable runs (HDTV)
- DVI-D (HDCP) output, compatible with HDMI (HDCP) video using Key Digital® HDMI / DVI-D adapter cables
- Select VGA (RGBHV) or Component Video output mode
- Horizontal and Vertical Position and Size control
- Key Digital's Clear Matrix Pro® and SDS (Super Digital Scaling) technology deliver world-class scaling of HDTV and SDTV input and output (user-selectable) resolutions, including NTSC and PAL
- Vertical and Horizontal Letterbox Zoom feature, to prevent monitor burn-in for Letterbox or Pillar-box images
- All controls are available via the front-panel pushbuttons and LCD, and through the RS232C (compatible with all control systems)

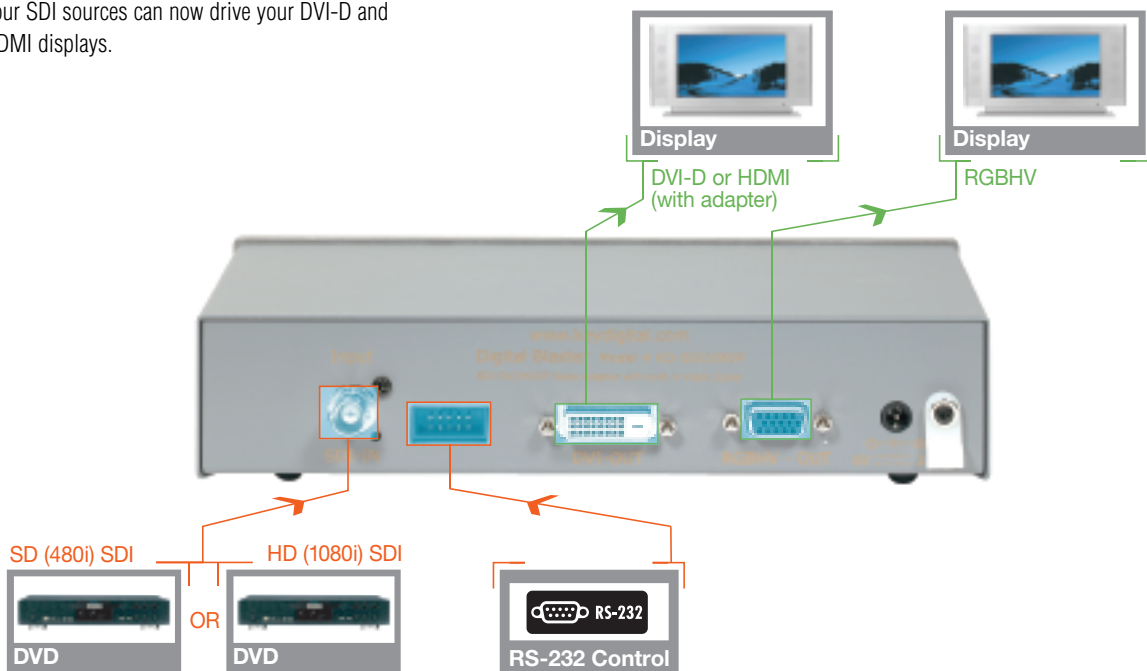

- CLEAR MATRIX PRO
- SDS SUPER DIGITAL SCALING
- DIGITAL EDGE DEE ENHANCEMENT
- HORIZONTAL OFFSET HOVO VERTICAL OFFSET
- DIGITAL VIDEO DVIX INTERNAL CLOCK EXCHANGE
- DVPC DIGITAL VIDEO PHASE CONTROLLER
- LHBC LINEAR HIGH BANDWIDTH CIRCUIT
- MULTI-LAYER BOARD TECHNOLOGY
- SURFACE MOUNT TECHNOLOGY
- tsf
- RS-232
- CRESTRON
- AMX
- ELAN HOME SYSTEMS™
- Control