

### Application Diagram

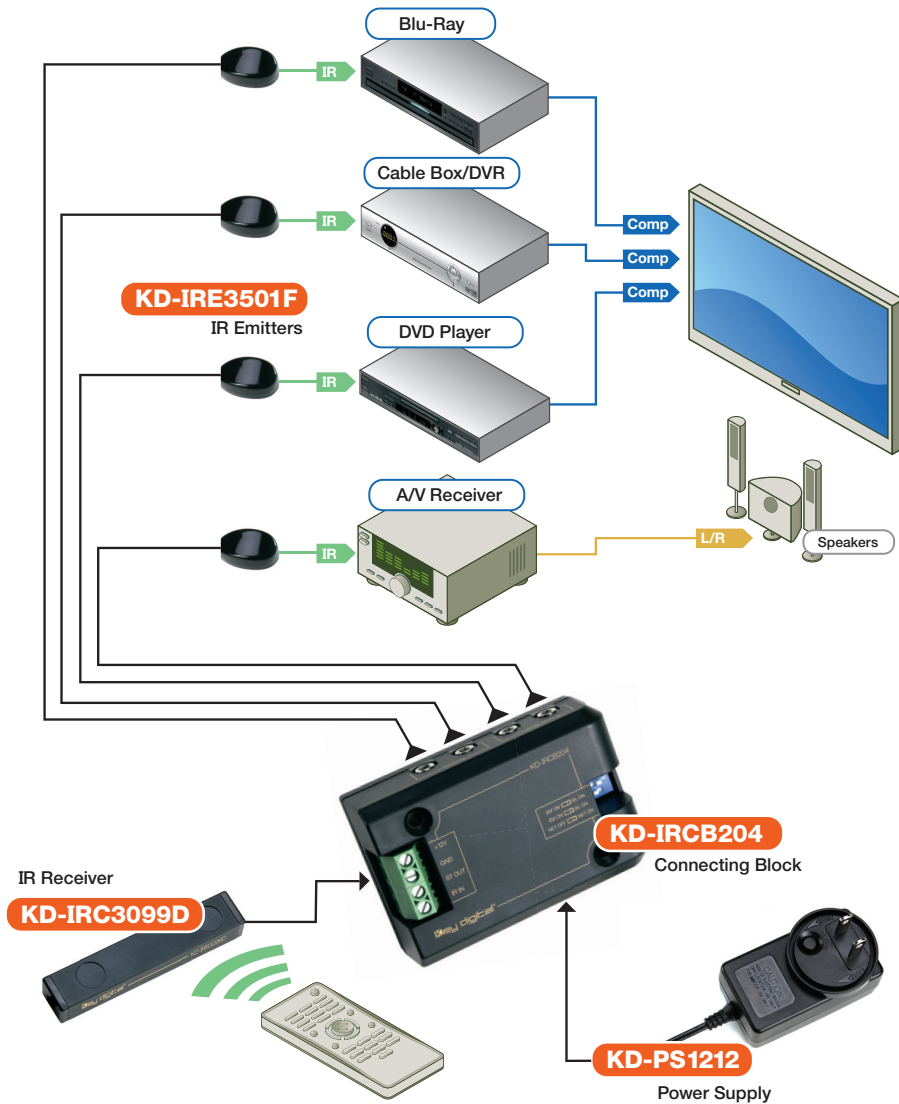

**CAUTION:** When unpacking the unit, make all hookups and connections before plugging in the Power Adapter provided with your unit. Do NOT apply power to the unit until all connections have been made. You MUST use the Power Supply provided with your unit or you VOID the Key Digital Warranty and risk damage to your unit and associated equipment.

### Important Product Warnings

1. Always test for proper operation of the unit before permanently securing to final location.
2. Please set all DIP switch configurations appropriately.
  - “BL ON” switches are only to be set to the on position when IR Blaster Emitters are in use.
  - “NET ON” switch is only to be set to the on position when utilizing lengthy cable runs.
  - See “Product Features” and “Emitter Blaster Installation” sections of this manual.

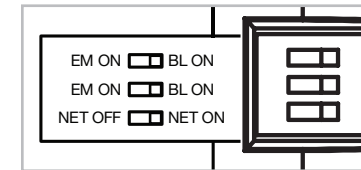

### Important Safety Instructions.

Please be sure to follow these instructions for safe operation of your unit

1. Read these instructions.
2. Keep these instructions.
3. Heed all warnings.
4. Follow all instructions.
5. Do not use this apparatus near water.
6. Clean only with dry cloth.
7. Do not block any ventilation openings. Install in accordance with the manufacturer's instructions.
8. Do not install near any heat sources such as radiators, heat registers, stoves, or other apparatus (including amplifiers) that produce heat.
9. Do not defeat the safety purpose of the polarized or grounding-type plug. A polarized plug has two blades with one wider than the other. A grounding type plug has two blades and a third grounding prong. The wide blade or the third prong are provided for your safety. If the provided plug does not fit into your outlet, consult an electrician for replacement of the obsolete outlet.
10. Protect the power cord from being walked on or pinched particularly at plugs, convenience receptacles, and the point where they exit from the apparatus.
11. Only use attachments/accessories specified by the manufacturer.
12. Unplug this apparatus during lightning storms or when unused for long periods of time.
13. Refer all servicing to qualified service personnel. Servicing is required when the apparatus has been damaged in any way, such as power-supply cord or plug is damaged, liquid has been spilled or objects have fallen into the apparatus, the apparatus has been exposed to rain or moisture, does not operate normally, or has been dropped.